

Custom Rockwell-Scale Diamond Indenters (Penetrators)

for most models of Newage Indentron[®], ME-2[®]
as well as other brands of Rockwell Hardness Testing Systems.

Standard Configuration Indenter – Extended Length¹

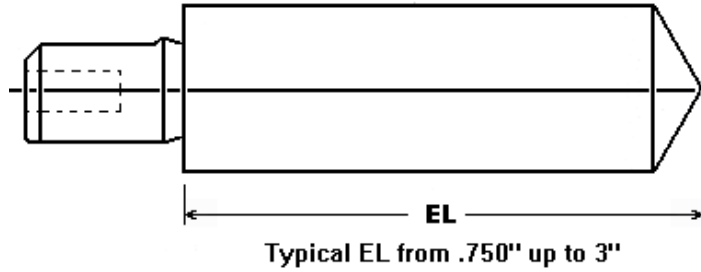

Standard Configuration Indenter – Short Form¹

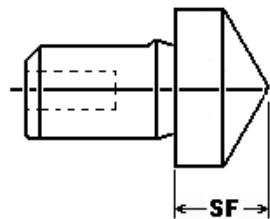

Slim Body – Regular and Extended Length Diamond Indenters
(Refer to notes at end of document for allowable loads)

Slim Body Style A²

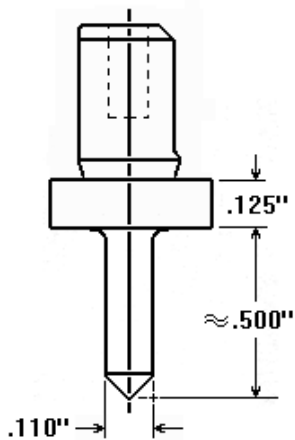

Slim Body Style B¹

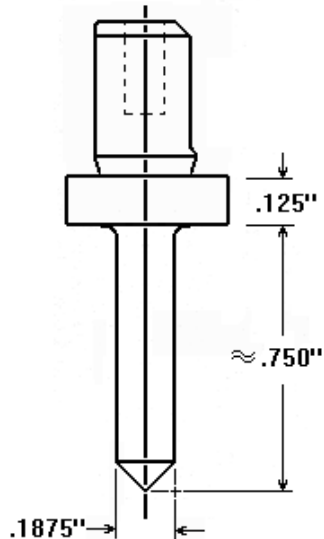

Slim Body Style C¹

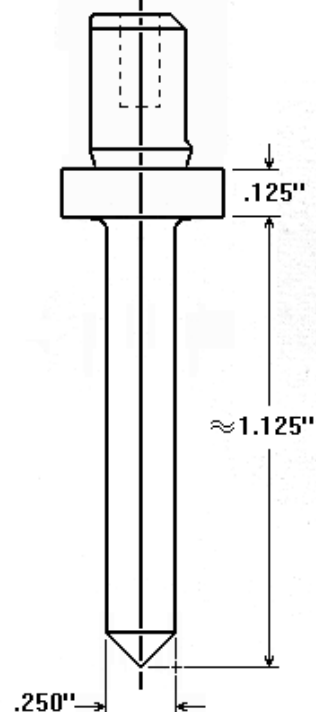

Single Cutaway Indenters – Regular and Extended Length¹

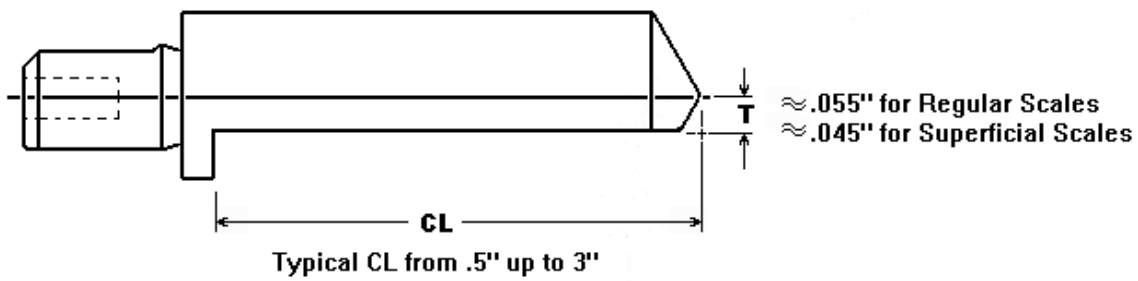

Double Taper Indenters¹

Double Taper Style A¹

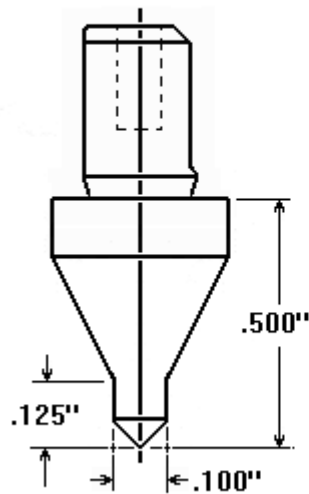

Double Taper Style B¹

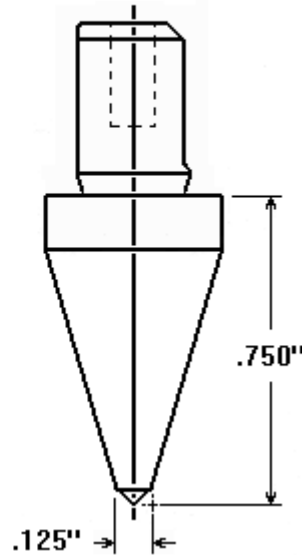

- 1 For use with all Regular and Superficial Rockwell Test Loads
- 2 For use with loads of 60Kg or less

® registered trademark of Instron Corporation

All special configuration diamond penetrators are made to order so dimensions provided are "typical" and can be modified to better suit your application. Above diagrams are not to scale and are provided for reference only. Contact Newage Testing Instruments for price and delivery on any diamond item. When calling please provide your hardness tester's make and model along with information about your application including the hardness scale you will use and the type of diamond you will need.



Newage Testing Instruments, Inc.

147 James Way
Southampton, PA 18966
(215) 526-2200 Fax (215) 526-2192
E-mail: info@newageinstruments.com
WEB: www.hardnesstesters.com